

Binwell Wastebasket

DESIGNED IN 2022

ASSEMBLY NOTES | REV 00

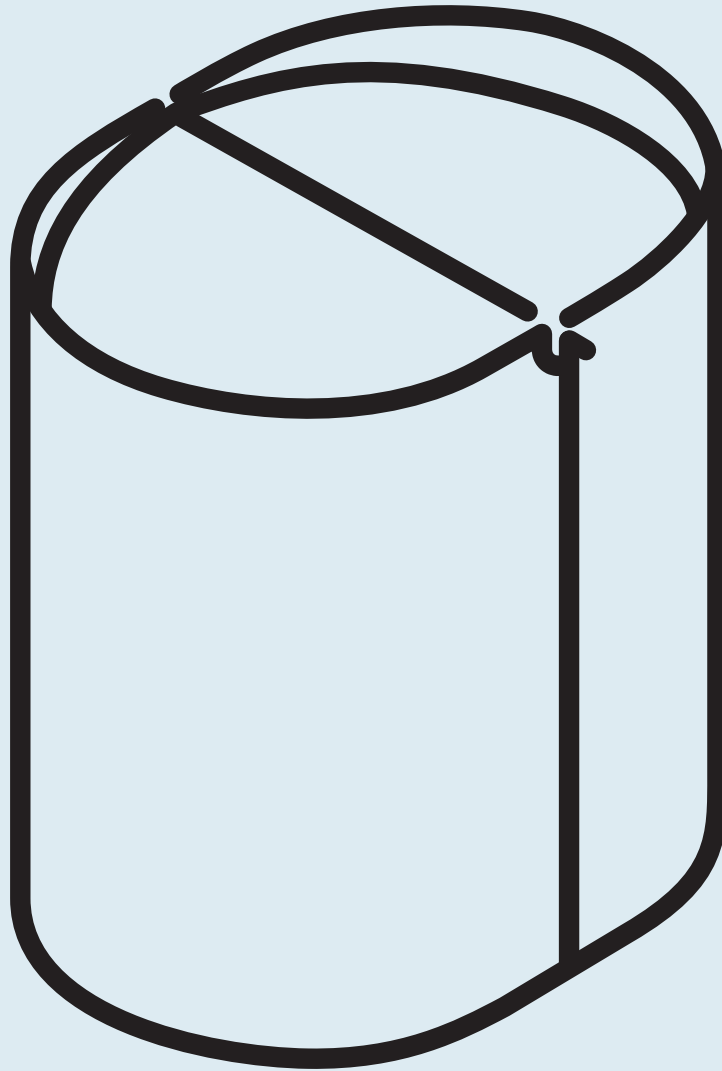
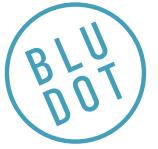

NEED A HAND?

Contact us at service@bludot.com or
844.425.8368 for assistance.

@BLUDOT

We design all our pieces in our Minneapolis studio. Follow
along on Instagram for some sneak peeks into the process.

Parts & Hardware

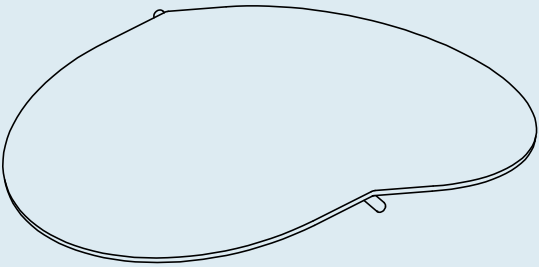

QTY 1

Lid

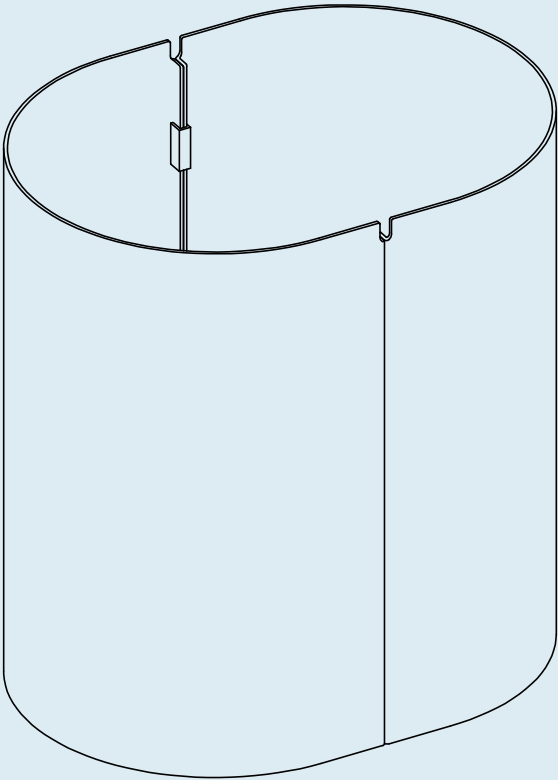

QTY 1

Wastebasket

Step 01

PLACE THE LID.

Position the lid on the wastebasket by aligning the attached rod with the cutouts as shown.

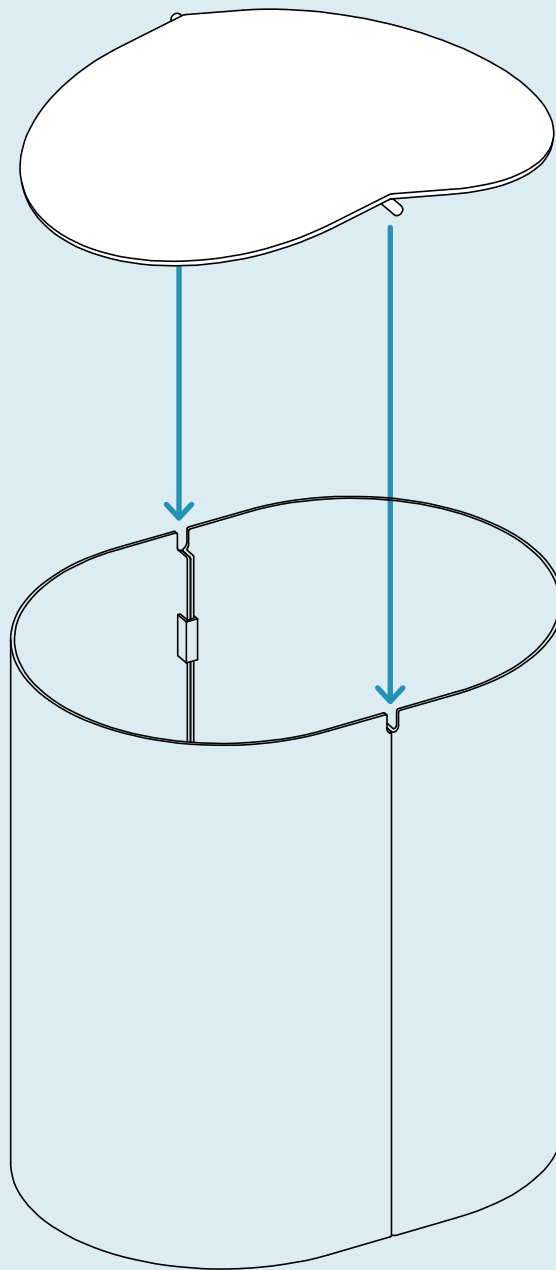

Additional Information

AVOID

Do not place liquids into the wastebasket. It is not a water tight container and is meant for dry waste only.

CLEAN

Clean with a slightly damp, soft cloth. To remove dirt and fingerprints, use a quality cleaner formulated for painted metal furniture. Wipe completely dry with a soft cloth.

