

# Untitled (Shelf)

DESIGNED IN 2007

ASSEMBLY NOTES | REV 01

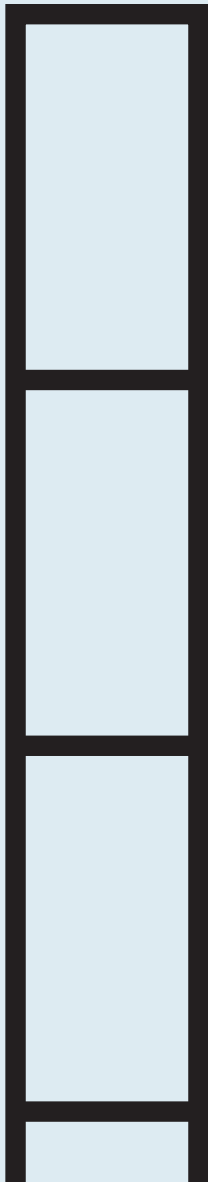
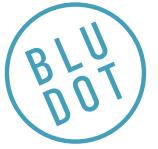

## NEED A HAND?

Contact us at [service@bludot.com](mailto:service@bludot.com) or  
**844.425.8368** for assistance.

## @BLUDOT

We design all our pieces in our Minneapolis studio. Follow  
along on Instagram for some sneak peeks into the process.

Parts & Hardware



QTY 2  
PT. 1218

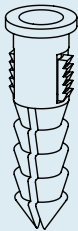

QTY 2  
PT. 8054

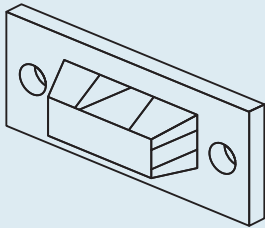

QTY 1  
PT. 8041

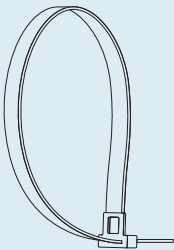

QTY 1  
PT. 8042

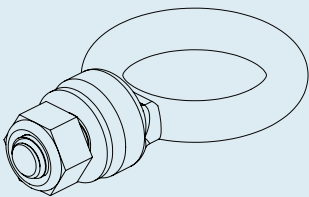

QTY 1  
Eyebolt

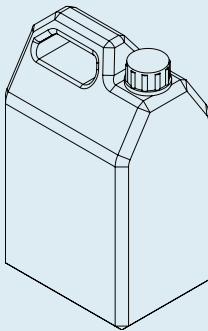

QTY 1  
Ballast

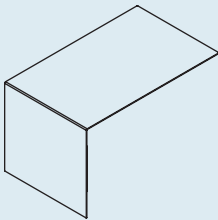

QTY 1  
Cover Panel

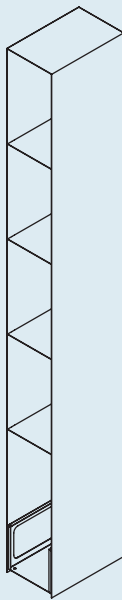

QTY 1  
Frame

# Step 01

## INSTALL EYEBOLT.

We recommend installing an anti-tip kit to prevent the shelf from tipping. Begin installation by attaching the eyebolt hardware through the back panel as shown.

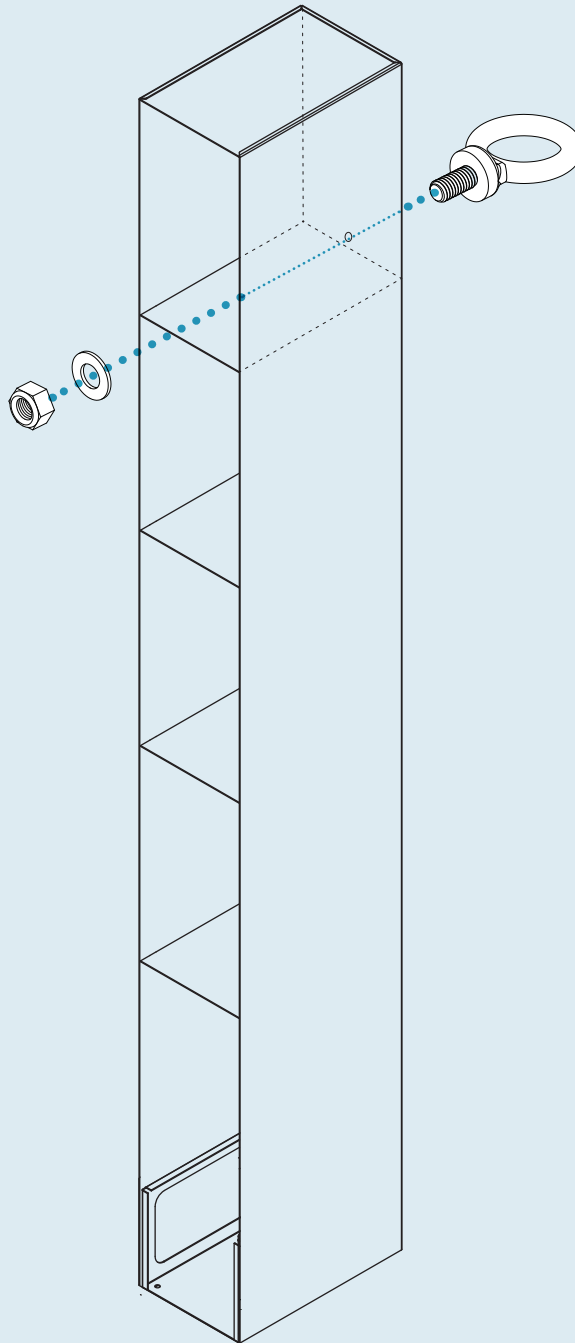

## Step 02

### INSTALL WALL BRACKETS.

Wall anchors and fasteners are included for installation into drywall. Please consult your local hardware professional to determine the hardware best suited for your wall type.

Position the wall bracket below the eyebolt as shown and mark the mounting hole locations.

If the mounting locations are not positioned on a stud, drill **15/64"** holes in the marked locations. Press wall anchors into drilled holes.

If the mounting locations are positioned on a stud, this step of installing wall anchors may be skipped. Instead, drill **7/64"** pilot holes in the marked locations.

Attach the wall brackets to the wall using the included fasteners as shown.

wall bracket 1"  
lower than eyebolt

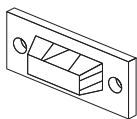
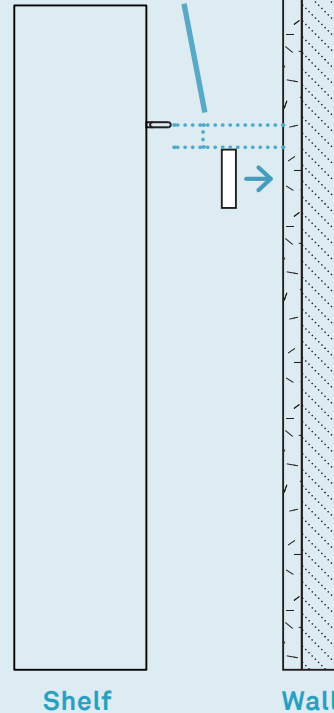

PT. 8041 x 1



PT. 8054 x 2



PT. 1218 x 2

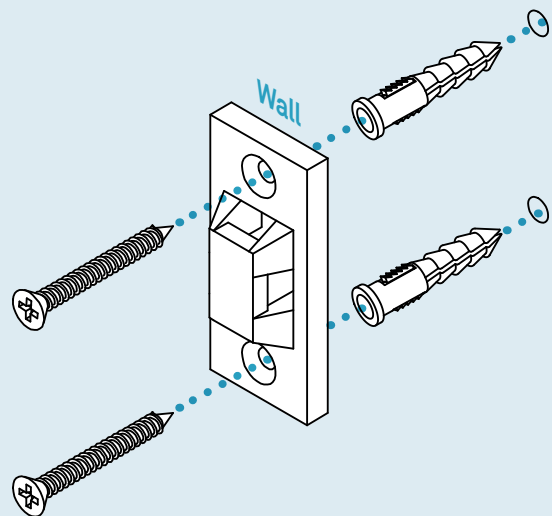

## Step 03

### SECURE THE SHELF.

Install and tighten the strap as shown to secure the frame.

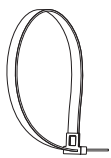
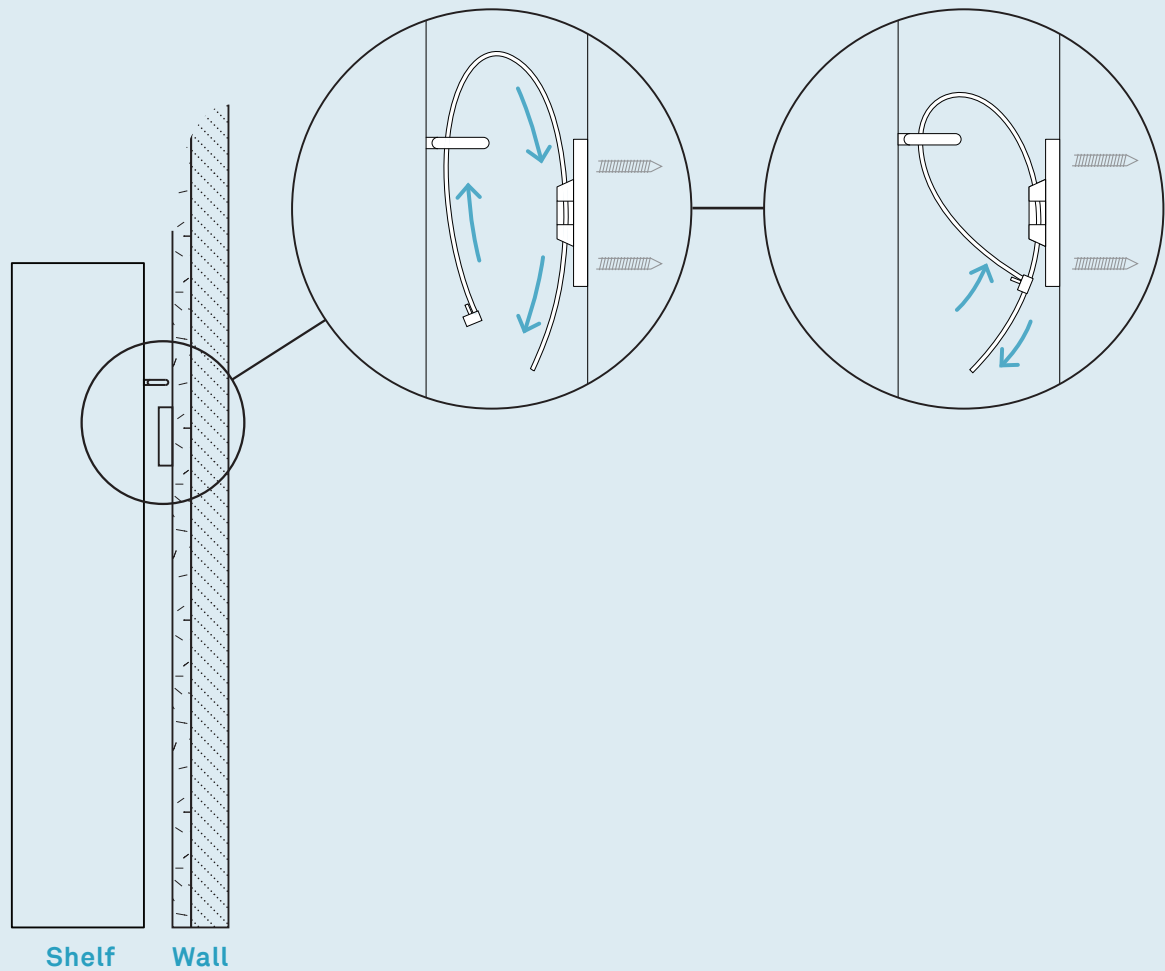

PT. 8042 x 1

## Step 04

### ADJUST FEET.

Adjust the adjustable feet at the base to make sure it is level.

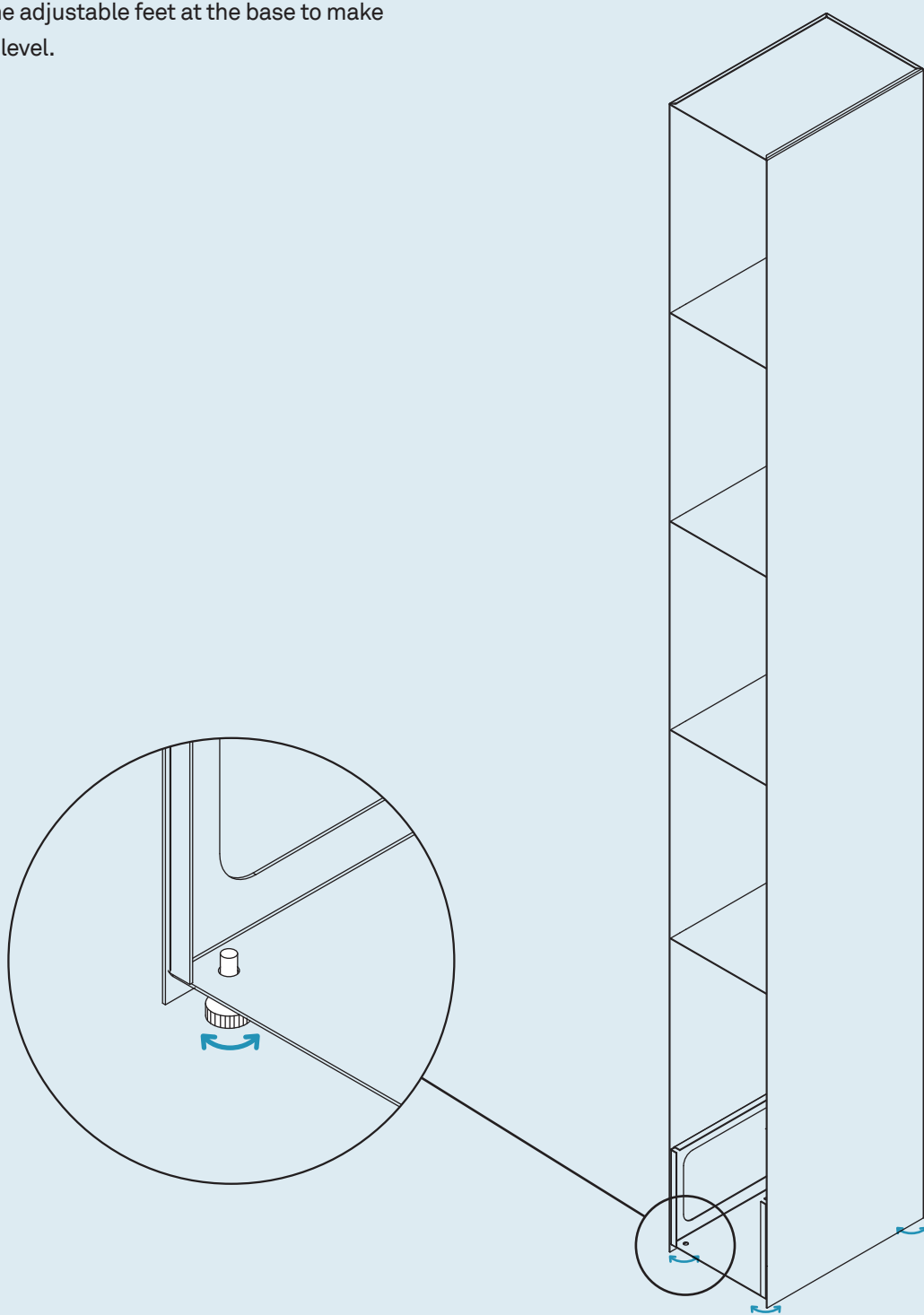

## Step 05

### FILLING THE BALLAST CONTAINER.

Carefully fill the provided ballast container with water or sand as shown. Once filled, screw the ballast container cap on securely.

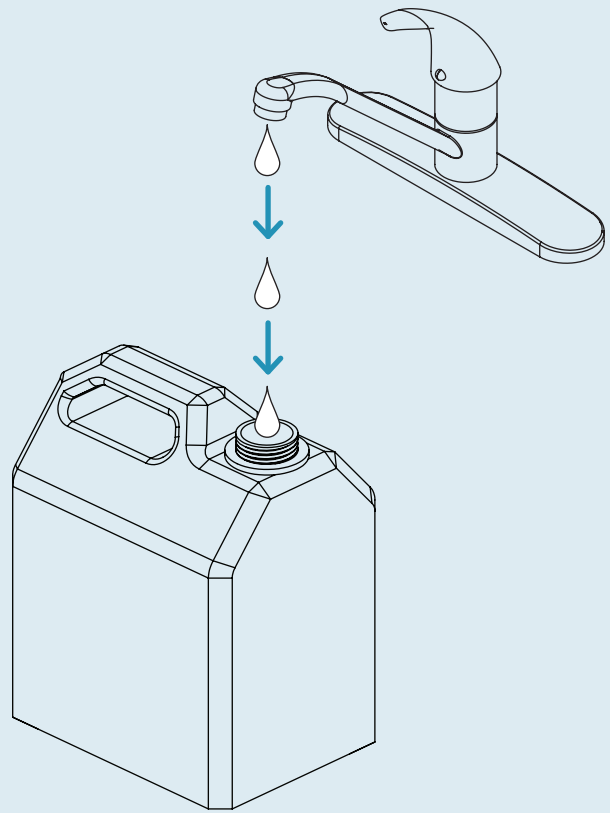

## Step 06

### INSTALLING THE BALLAST CONTAINER.

Insert the ballast container into the frame and rotate it as shown.

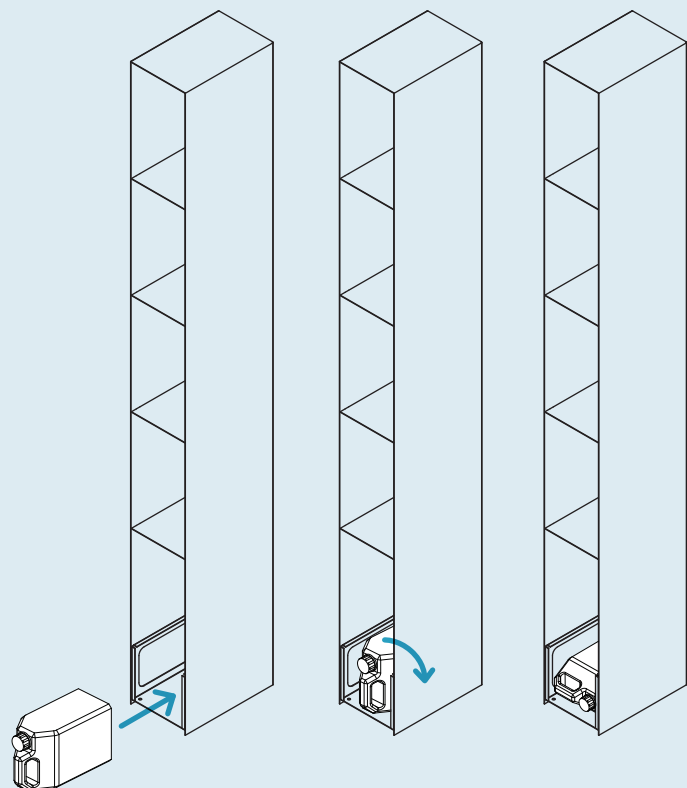

## Step 07

### INSTALLING THE COVER PANEL.

Install the cover panel as shown by inserting the cover panel and lowering it into place over the ballast.

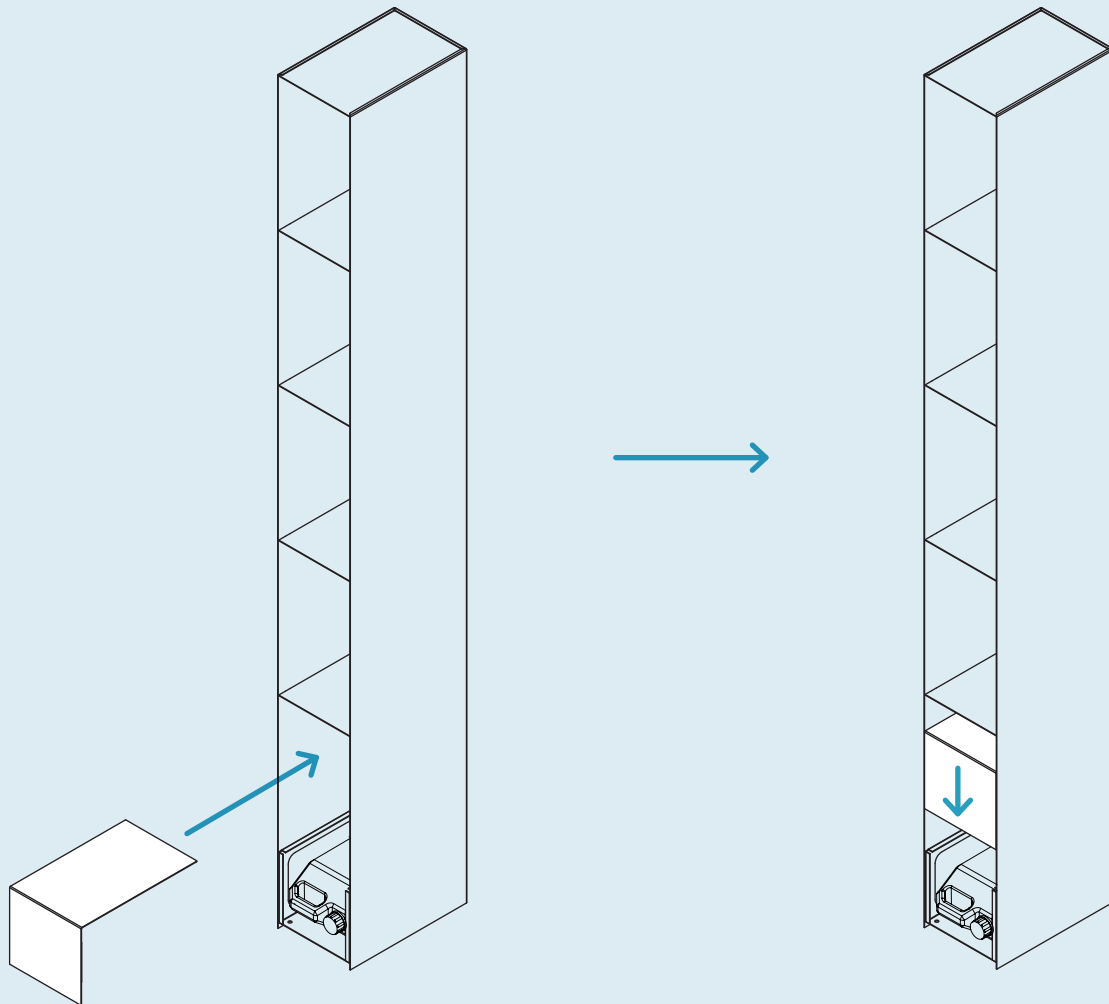

## Additional Information

### NOTE

Do not use abrasive cleaners on painted metal as it may affect the surface finish.

### CLEAN

Clean with a slightly damp, soft cloth. To remove dirt and fingerprints, use a quality cleaner formulated for metal furniture. Wipe completely dry with a soft cloth.

